



PLAT BOOK

OF

OTOE COUNTY

Nebraska

THE FIRST NATIONAL BANK

SYRACUSE, NEBRASKA

CAPITAL, SURPLUS and UNDIVIDED PROFITS \$230,000.00

Member of Federal Deposit Insurance Corporation

Maximum Insurance \$10,000.00

Price \$3.00

THE 1956 ATLAS OF

OTOE COUNTY

NEBRASKA

LEGEND

HIGHWAYS	
Federal	
State	
County	
Paving	
Bituminous	
Metallic	
Dirt	
RAILROAD	
SCHOOL	
CHURCH	
CEMETERY	

WITH TOWNSHIP PLATS CORRECTED TO DECEMBER 21, 1956

All Rights Reserved
R. C. Booth Enterprises
HARLAN, IOWA

INDEX

<u>TOWNSHIP</u>	<u>PAGE</u>
BELMONT	23
BERLIN	7
DELEWARE	21
FOUR MILE	25
HENDRICKS	37
MC WILLIAMS	31
NORTH BRANCH	9
NORTH PALMYRA	13
NORTH RUSSELL	11
OSAGE	33
OTOE	27
ROCK CREEK	29
SOUTH BRANCH	35
SOUTH PALMYRA	15
SOUTH RUSSELL	17
SYRACUSE	19
WYOMING	5

R 13 - R 14

COUNT

CASS

BERLIN

WYOMING

TOWNSHIP 9 NORTH - RANGE 13&14 EAST OF 6TH P.M
OTOE COUNTY, NEBRASKA

PAGE 5

TWP

TWP FOUR MILE

BELMONT

TWP

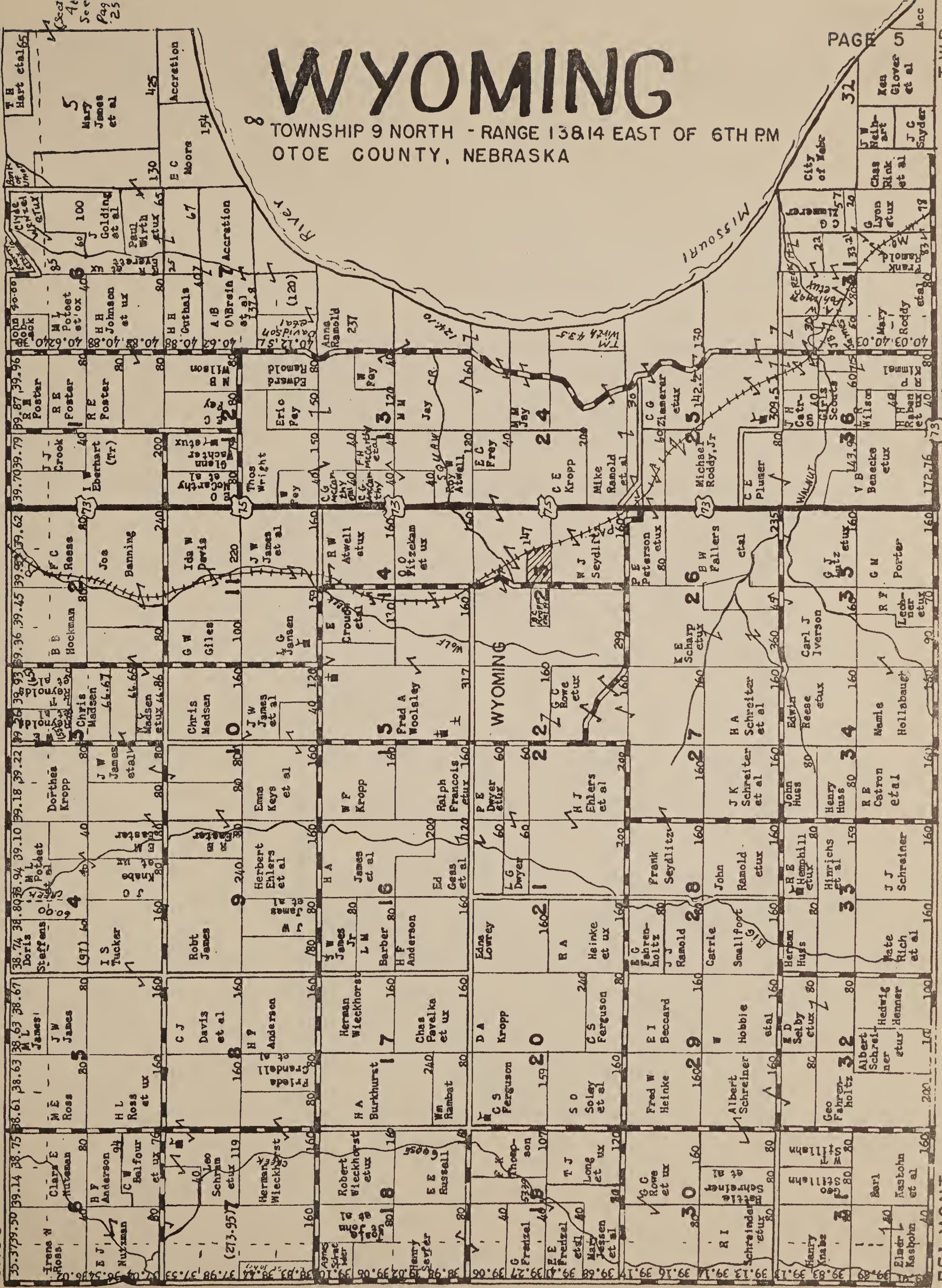

See Page 25

Accretion

154

130

67

60

80

80

80

80

80

80

80

80

80

80

80

80

80

80

80

80

80

80

80

80

80

80

80

80

80

425

130

67

80

80

80

80

80

80

80

80

80

80

80

80

80

130

67

80

80

80

80

80

80

80

80

80

80

80

80

80

80

130

67

80

80

80

80

80

80

80

80

80

80

80

80

80

80

130

67

80

80

80

80

80

80

80

80

80

80

80

80

80

80

130

67

80

80

80

80

80

80

80

80

80

80

80

80

80

80

130

67

80

80

80

80

80

80

80

80

80

80

80

80

80

80

130

67

80

80

80

80

80

80

80

80

80

80

80

80

80

80

130

67

80

80

80

80

80

80

80

80

80

80

80

80

80

80

130

67

80

80

80

80

80

80

80

80

80

80

80

80

80

80

130

67

80

80

80

80

80

80

80

80

80

80

80

80

80

80

130

67

80

80

80

80

80

80

80

80

80

80

80

80

80

80

130

67

80

80

80

80

80

80

80

80

80

80

80

80

80

80

130

67

80

80

80

80

80

80

80

80

80

80

80

80

80

80

130

67

80

80

80

80

80

80

80

80

80

80

80

80

80

80

130

67

80

80

80

80

80

80

80

80

80

80

80

80

80

80

130

67

80

80

80

80

80

80

80

80

80

80

80

80

80

80

130

67

80

80

80

80

80

80

80

80

80

80

80

80

80

80

130

67

80

80

80

80

80

80

80

80

80

80

80

80

80

80

130

67

80

BERLIN

TOWNSHIP 9 NORTH - RANGE 12 EAST OF 6TH P.M.

OTOE COUNTY, NEBRASKA



DELAWARE

TWP 9

WYOMING

NORTH BRANCH

TOWNSHIP 9 NORTH - RANGE 11 EAST OF 6TH P.M.
OTOE COUNTY, NEBRASKA

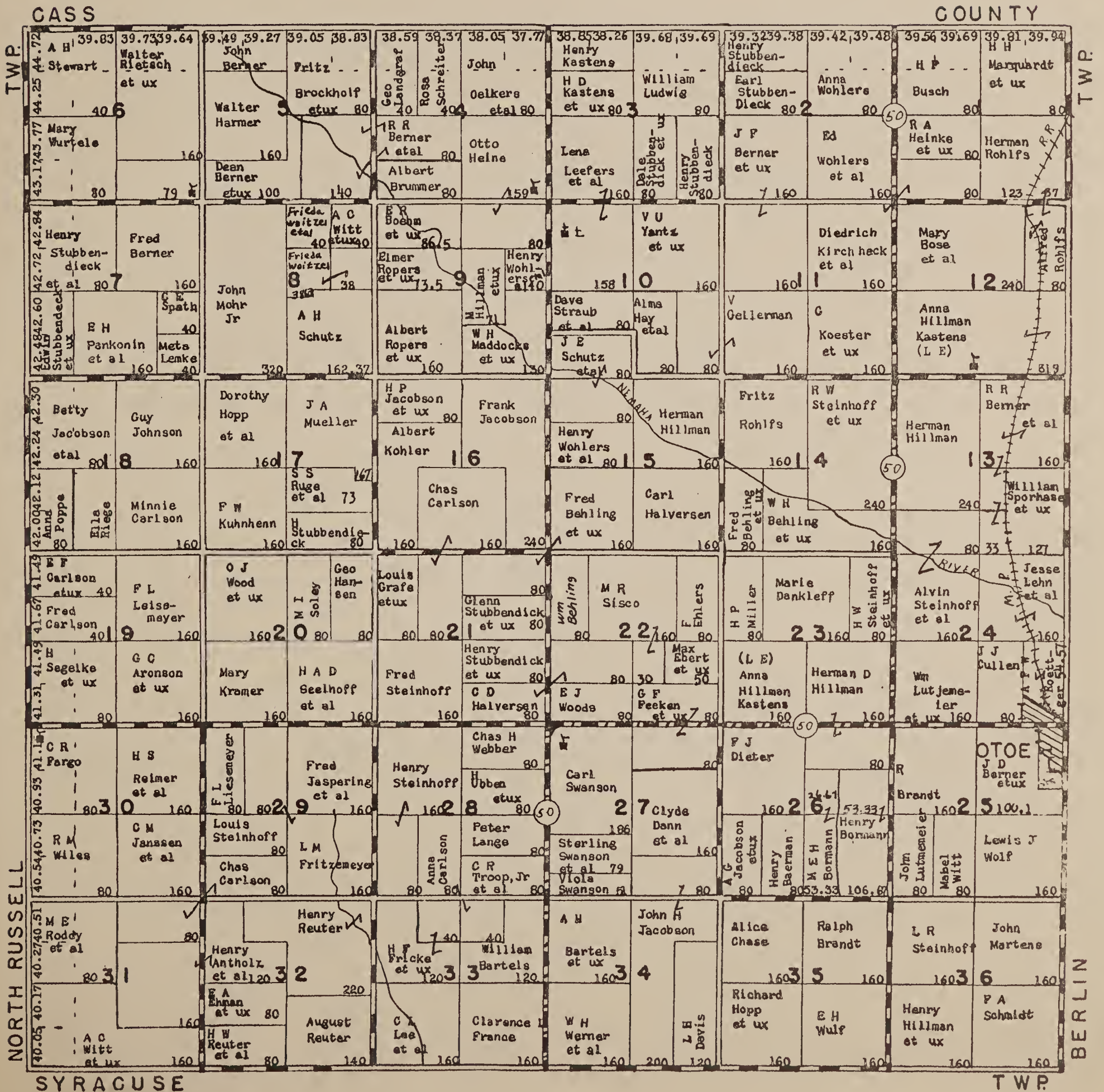

SYRACUSE

TWP.

NORTH RUSSELL

TOWNSHIP 9 NORTH - RANGE 10 EAST OF 6TH P.M.

OTOE COUNTY, NEBRASKA

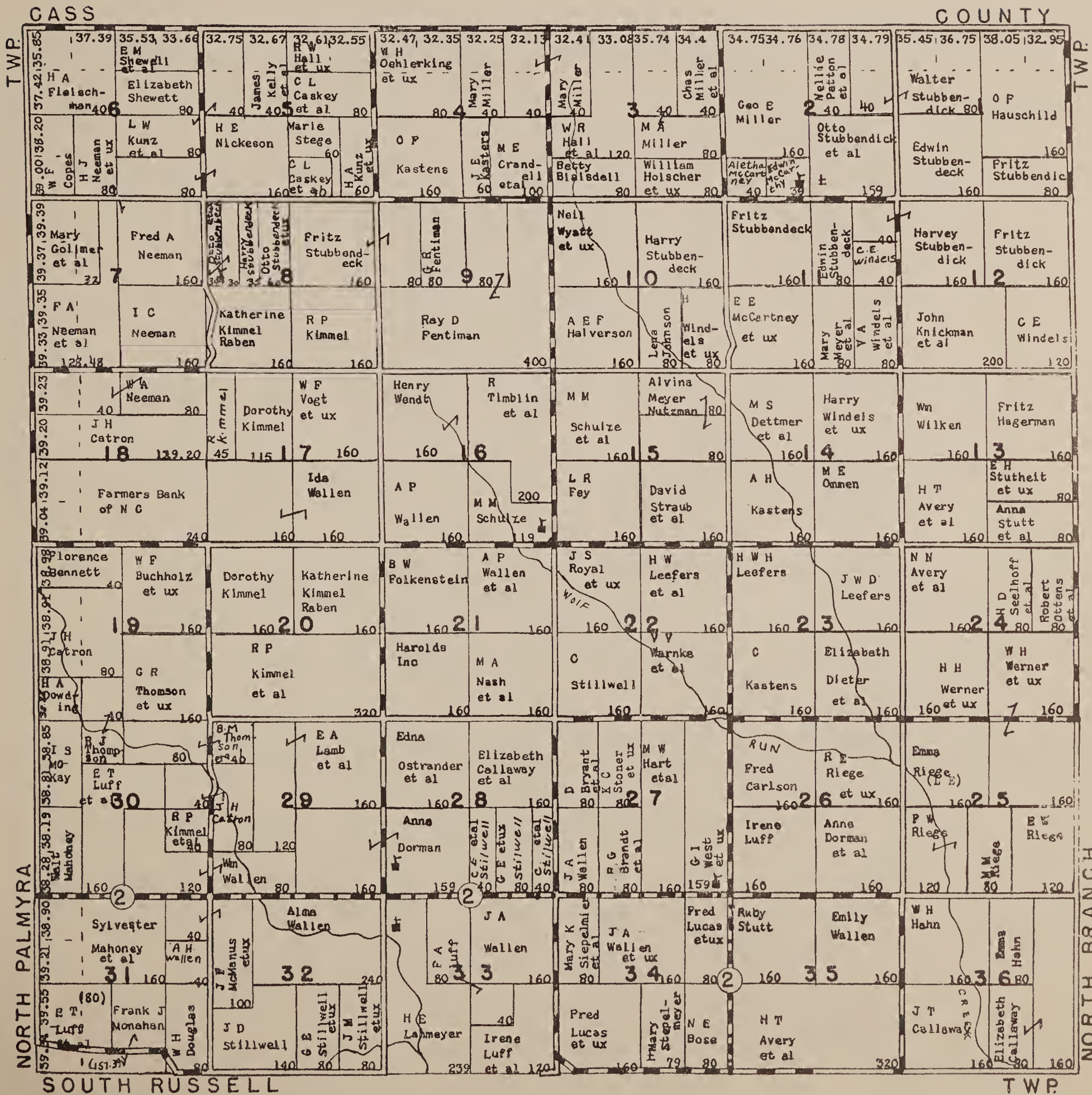

SOUTH RUSSELL

TWP.

NORTH PALMYRA

TOWNSHIP 9 NORTH - RANGE 9 EAST OF 6TH P. M.

OTOE COUNTY, NEBRASKA

SMALL LAND OWNERS

- 1 Sec 34 Fred Seeman-15a
- 2 Sec 34 Clara Gellerman-8.20a
- 3 Sec 34 P Mehoney-5a
- 4 Sec 34 Farmers Elevator Co-5.12a

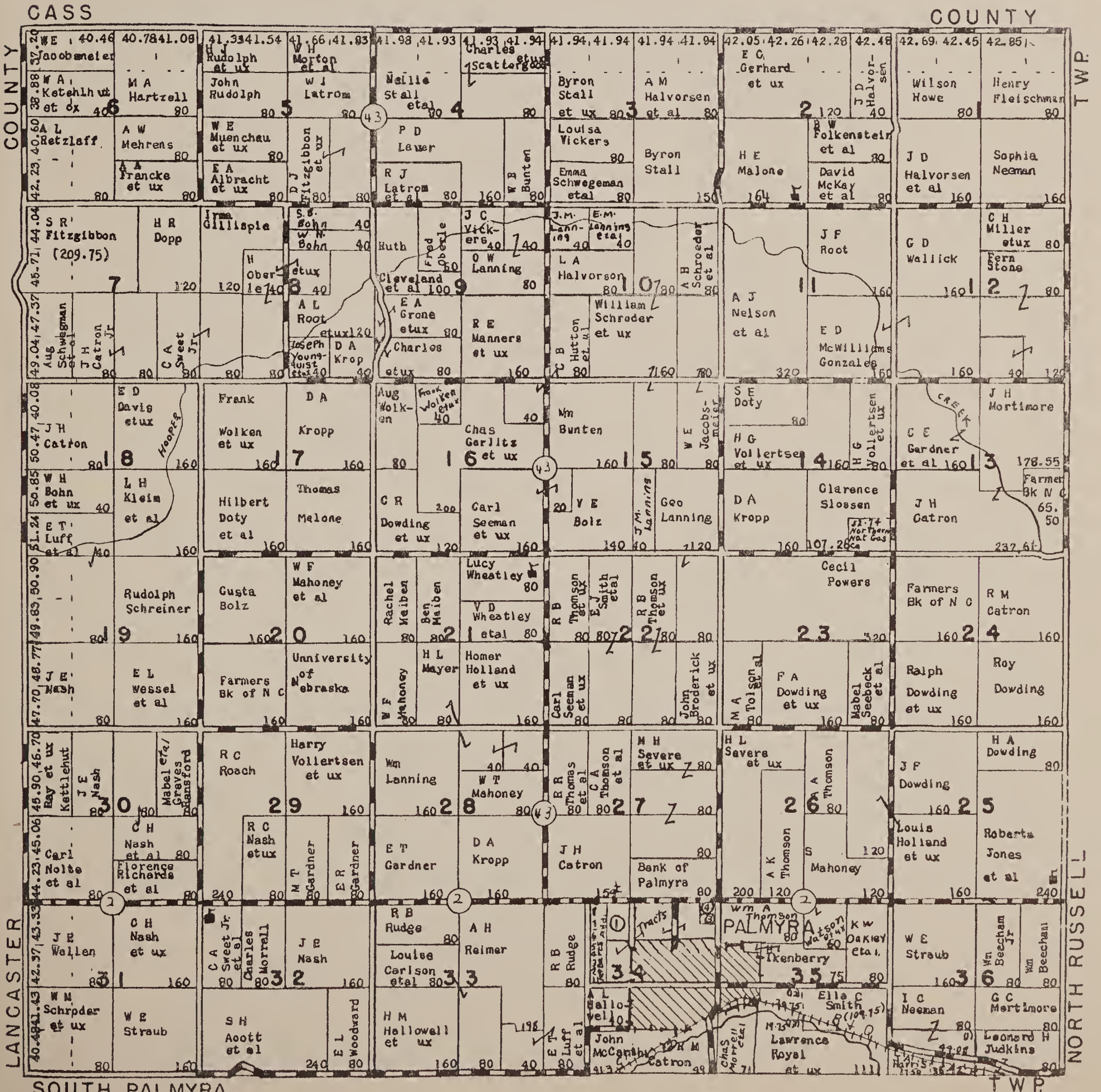

SOUTH PALMYRA

TOWNSHIP 8 NORTH - RANGE 9 EAST OF 6TH P.M.

OTOE COUNTY, NEBRASKA

SMALL LAND OWNERS
1 Sec 3 John McCarthy-23.2a



SYRACUSE

TOWNSHIP 8 NORTH - RANGE 11 EAST OF 6TH P.M.

OTOE COUNTY, NEBRASKA

SMALL LAND OWNERS
1 Sec 35 E M Pohlman-42,69a

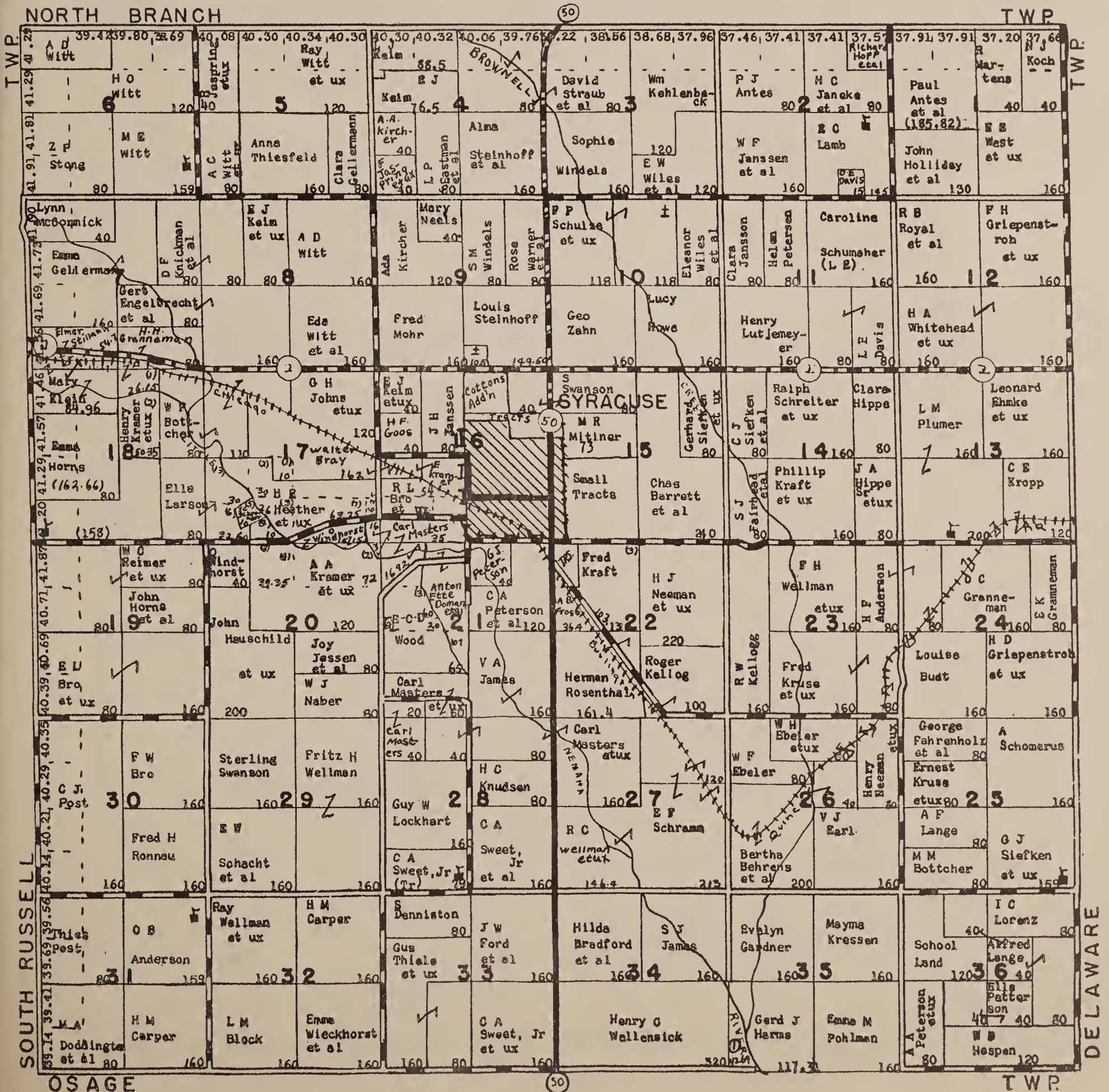

DELAWARE

TOWNSHIP 8 NORTH - RANGE 12 EAST OF 6TH P.M.

OTOE COUNTY, NEBRASKA

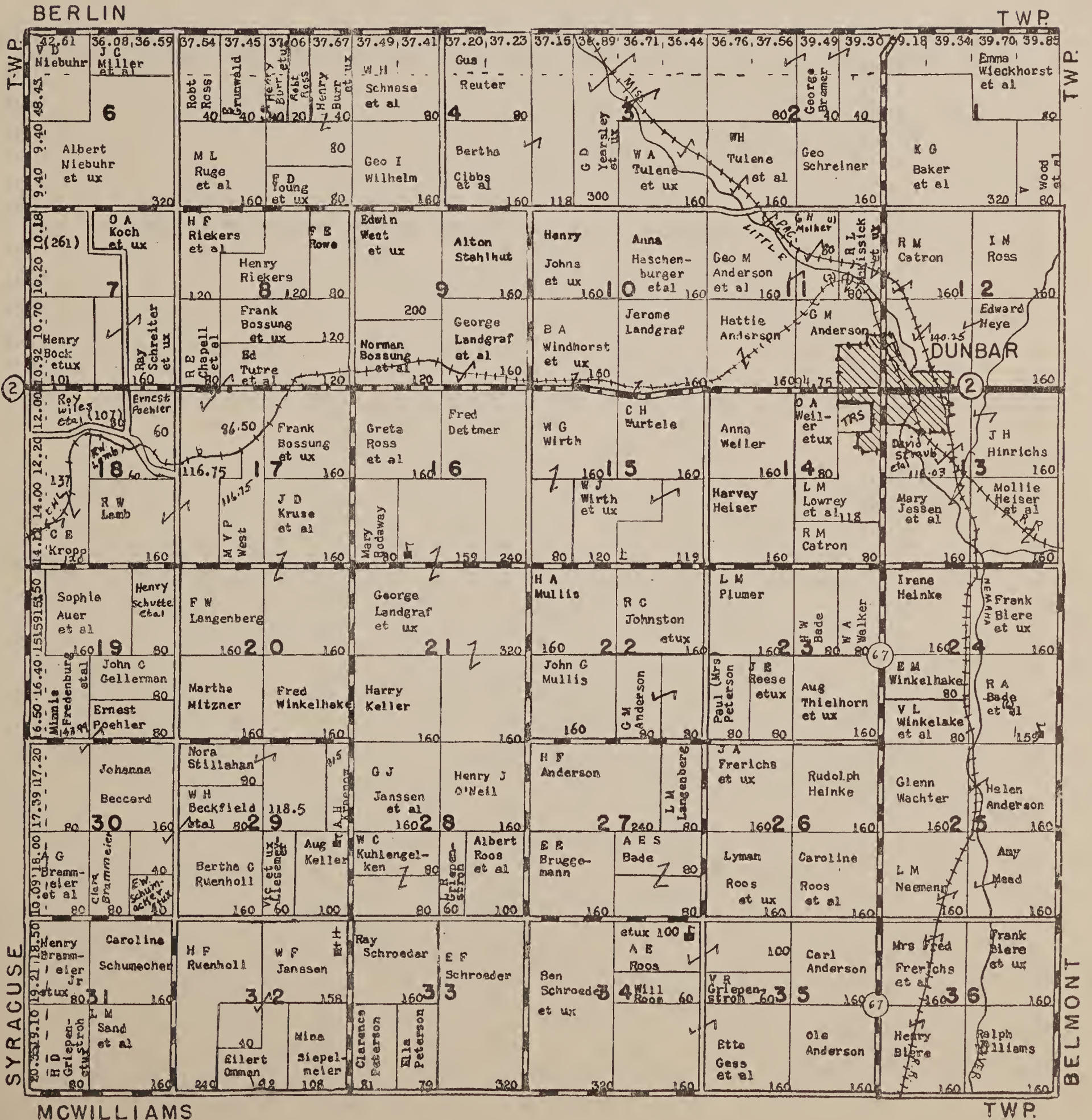

MCWILLIAMS

TWP.

BELMONT

TOWNSHIP 8 NORTH - RANGE 13 EAST OF 6TH P.M.

OTOE COUNTY, NEBRASKA

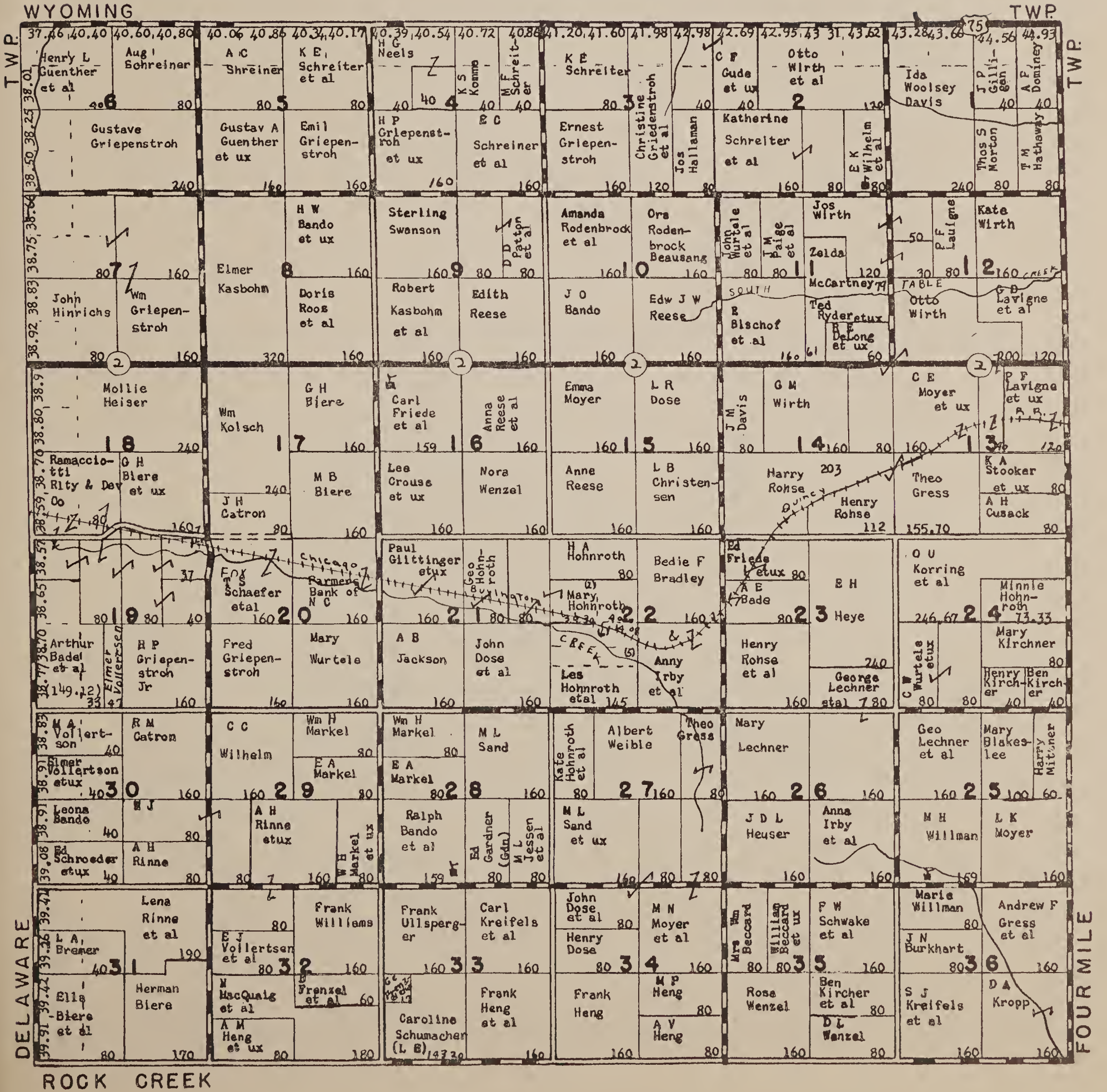

FOUR MILE

TOWNSHIP 8 NORTH - RANGE 14 & 15 EAST OF 6TH P.M.

OTOE COUNTY, NEBRASKA

SMALL LAND OWNERS

- 1 Sec 5 W H Ornderff, et ux-5a
- 2 Sec 5 E B White, et al-5a
- 3 Sec 5 C M Bobbitt, et ux-10a
- 4 Sec 5 H L Stahlhut-10a
- 5 Sec 5 Lulu Herrick, et al-10a
- 6 Sec 7 J L Hall-8, 25a
- 7 Sec 21 E Homeyer
- 8 Sec 5 R H Wurtele-10a
- 9 Sec 17 W H Gosch-10a

(From page 5 - Wyoming)

T 9 N - R 14 E

TWP.

WYOMING

BELMONT

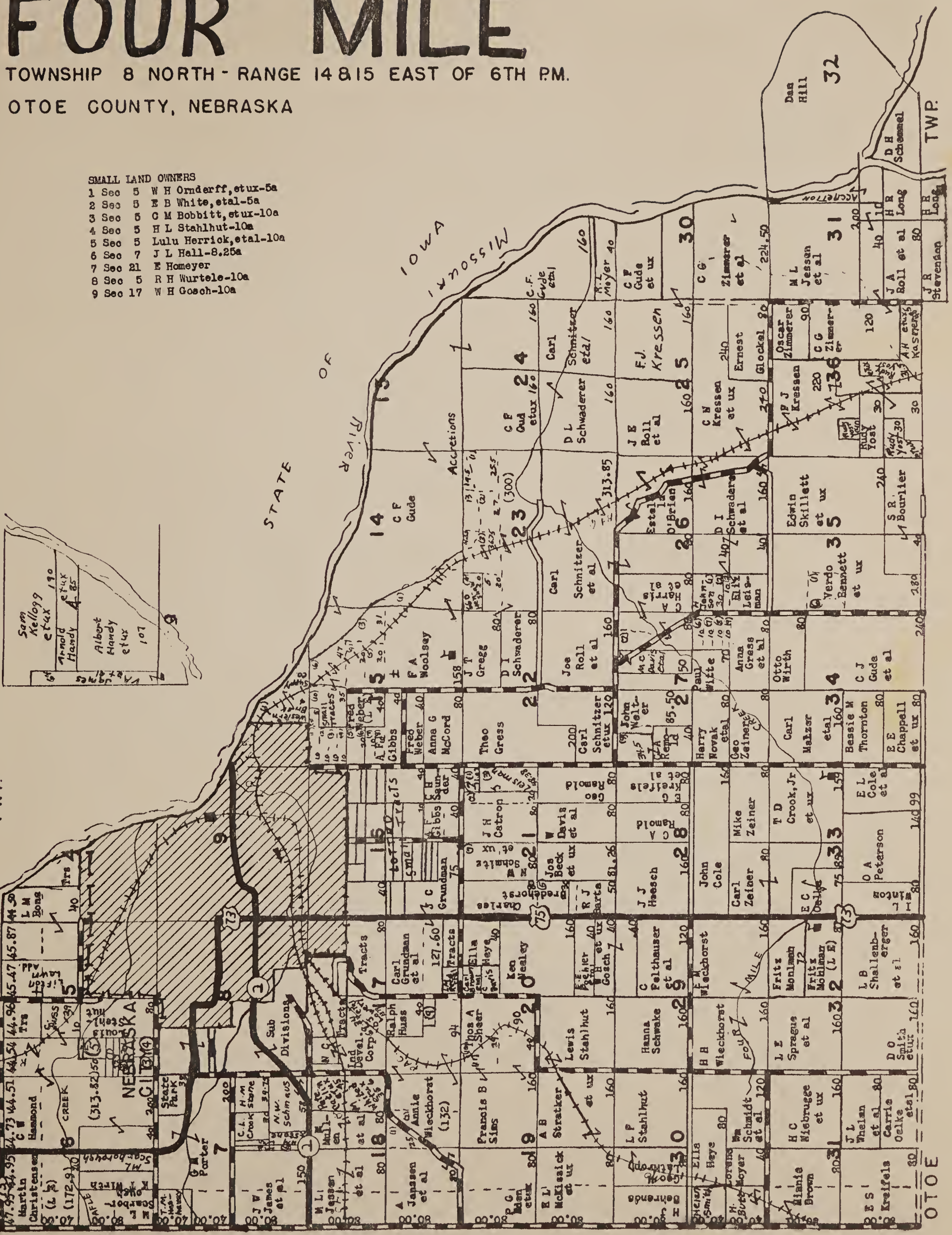

OTOE

OTOE

TOWNSHIP 7 NORTH-RANGE 14815 EAST OF 6TH P.M.
OTOE COUNTY, NEBRASKA

FOUR MILE

SMALL LAND OWNERS
R-14 1 Sec 11 I I Winton-13.5a
R-14 2 Sec 2 S R Bourlier-6.88a
R-14 3 Sec 23 J T Hartley, et ux-5a
R-15 4 Sec 30 W H Bremaston, 15a
R-15 5 Sec 31 A B Hadnise-10a
R-15 6 Sec 19 Dot Crook-15a
R-15 7 Sec 19 Dot Crook, et al-15a

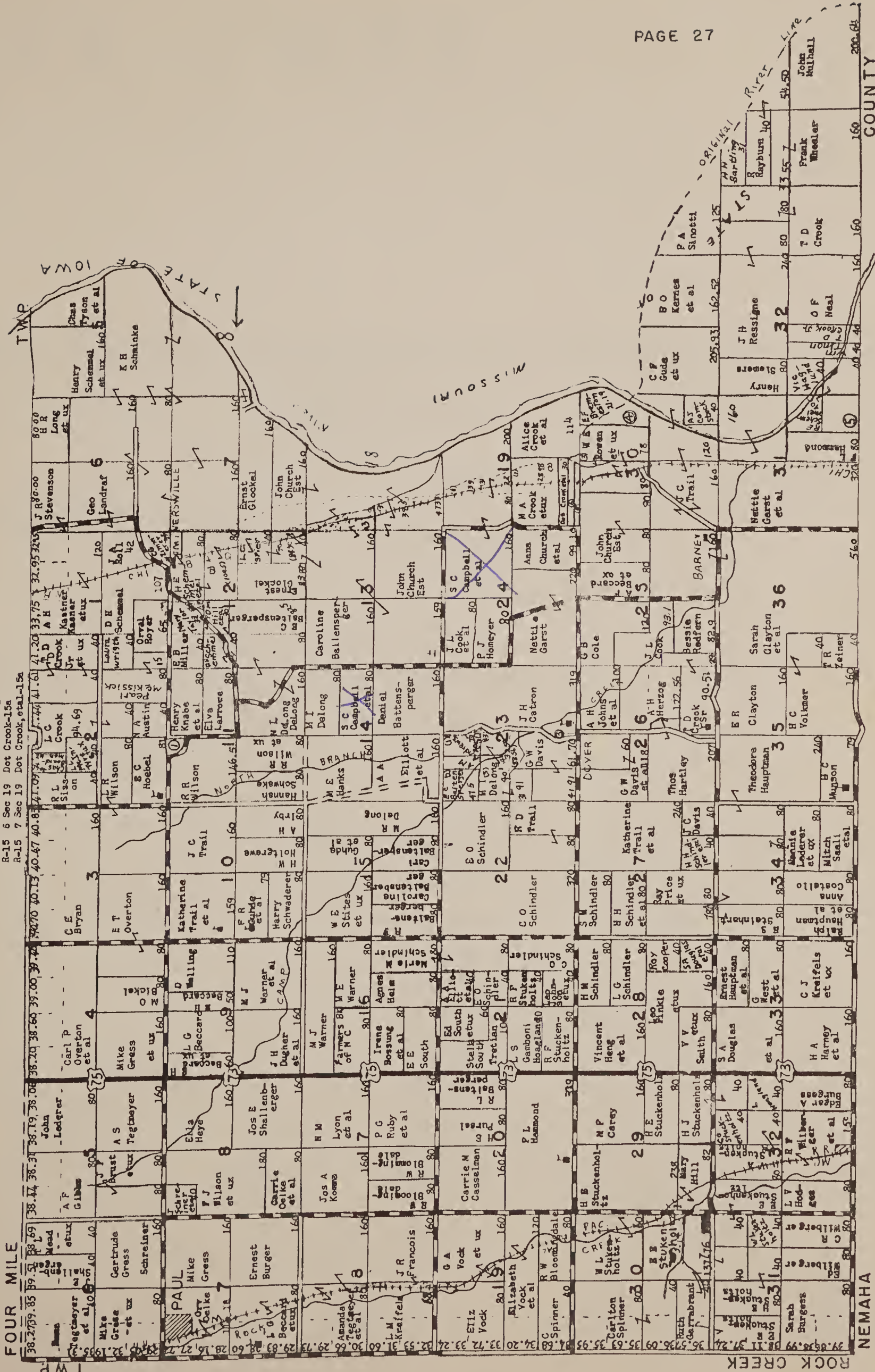

ROCK CREEK

TOWNSHIP 7 NORTH - RANGE 13 EAST OF 6TH P.M.

OTOE COUNTY, NEBRASKA

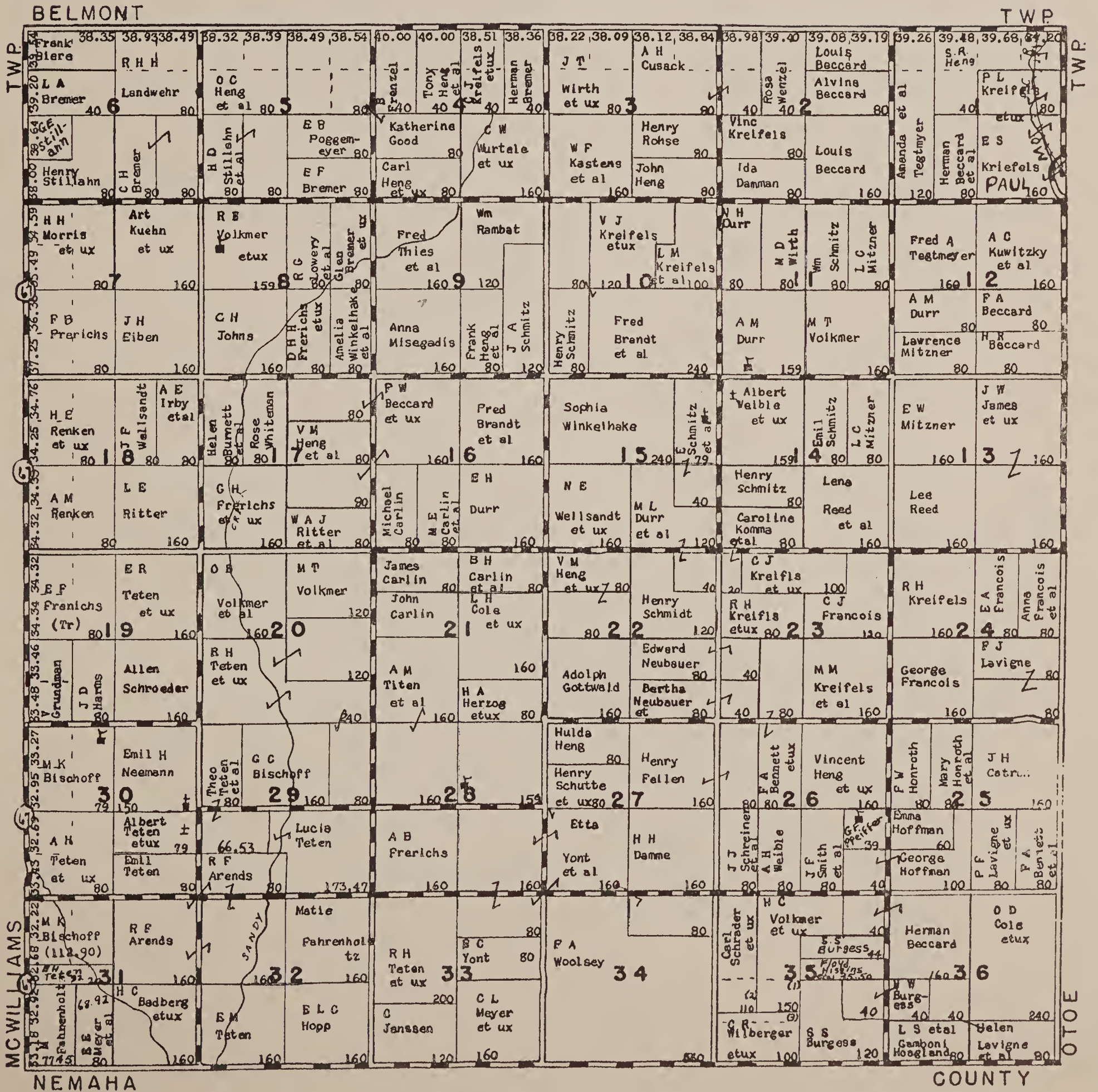

NEMAHA

COUNTY

MC WILLIAMS

TOWNSHIP 7 NORTH - RANGE 12 EAST OF 6TH P.M.

OTOE COUNTY, NEBRASKA

SMALL LAND OWNERS
1 Sec 36 A A Damme-16.32a



JOHNSON

COUNTY NEMAHA

COUNTY

OSAGE

TOWNSHIP 7 NORTH - RANGE 11 EAST OF 6TH P.M.
OTOE COUNTY, NEBRASKA

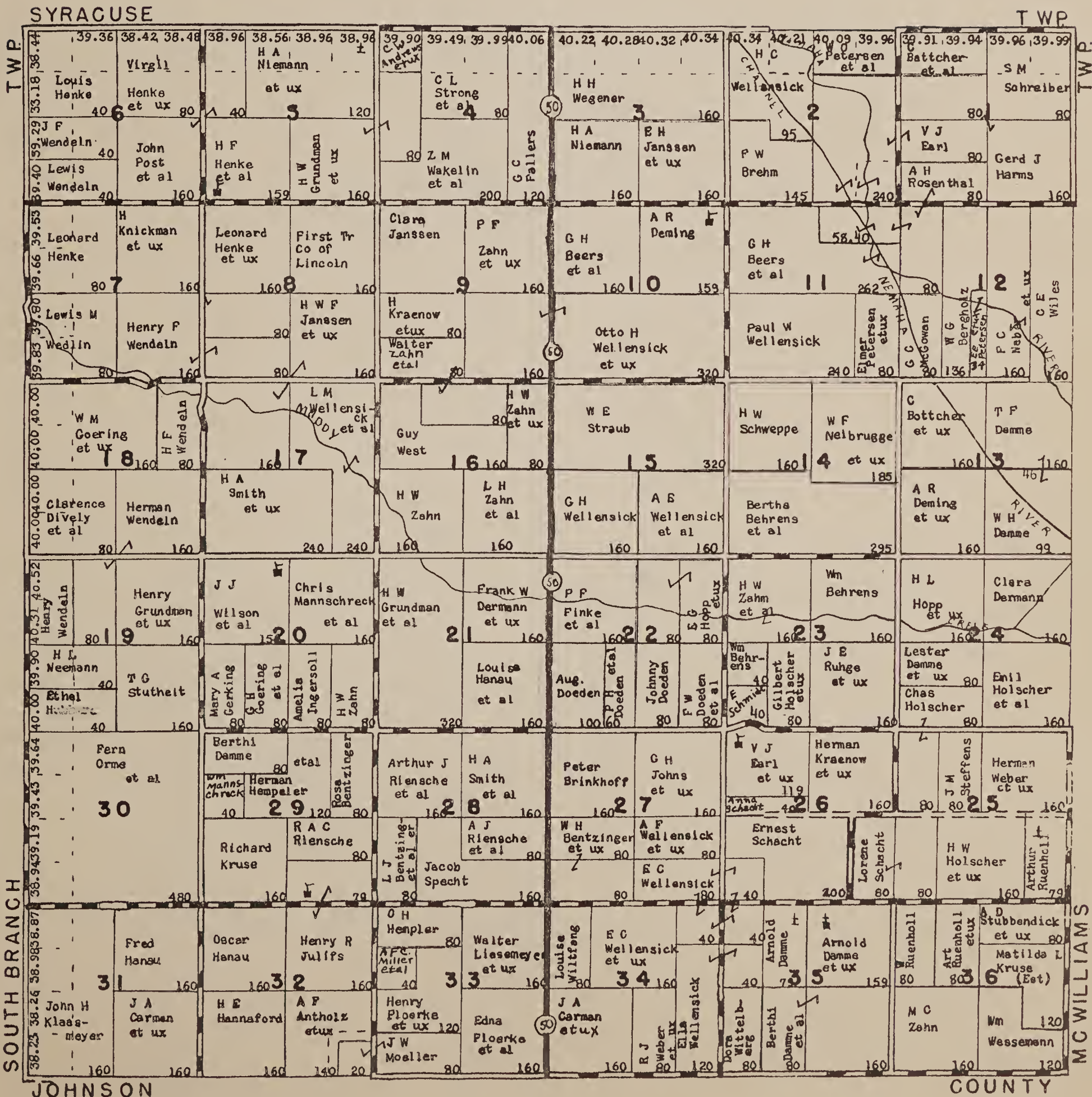

SOUTH BRANCH

TOWNSHIP 7 NORTH - RANGE 10 EAST OF 6TH P.M.

OTOE COUNTY, NEBRASKA.

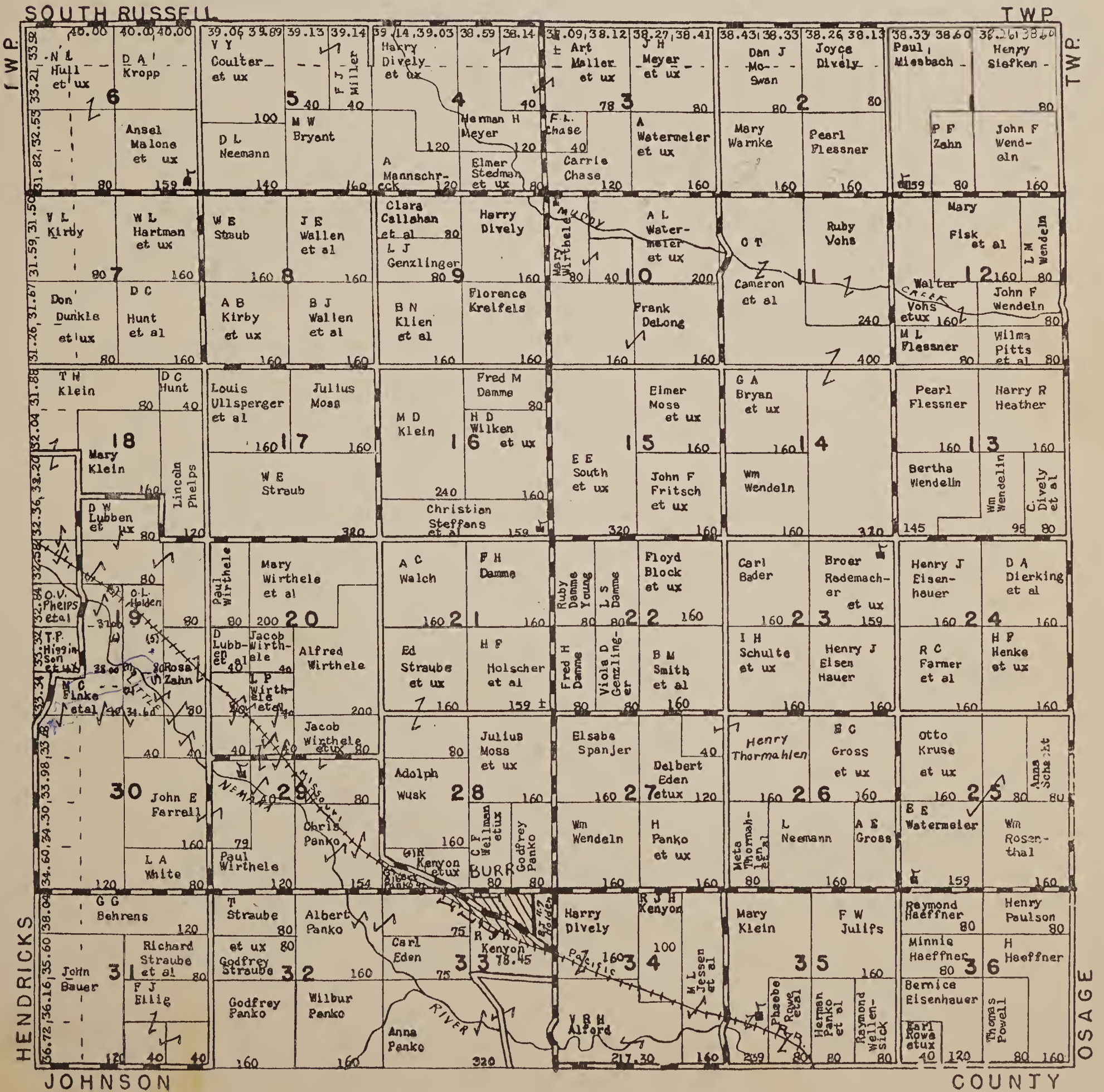

JOHNSON

COUNTY

OSAGE

88