

**GENERAL LEGEND**

- |   |   |
|---|---|
| <b>ROADS AND ROADWAY FEATURES</b>           | <b>FARM UNITS, DWELLINGS, ETC.</b>  |
| PRIMITIVE ROAD                              | FARM UNIT (FARM UNITS SHOWN IN MUNICIPAL LIMITS INDICATE FARM BUILDINGS FOR FARM USE) |
| UNIMPROVED ROAD                             | DWELLING OTHER THAN FARM  |
| GRADED AND DRAINED ROAD                     | CEMETERY  |
| GRAVEL GRADED AND DRAINED ROAD              | CHURCH WITH CEMETERY ADJACENT   |
| PAVED ROAD                                  | HOSPITAL  |
| STREETS IN UNINCORPORATED AREAS             | WELL  |
| COUNTY MAJOR COLLECTOR                      | TOLL HOUSE, STATE PORT OF ENTRY, OR WEIGHT STATION                                    |
| ROUTE NUMBER                                | FIRST AID STATION OR HEALTH CENTER  |
| POINTS BETWEEN WHICH DISTANCES ARE MEASURED |   |
| U.S. NUMBERED HIGHWAY                       |   |
| STATE HIGHWAY SYSTEM                        |   |
|   | <b>CONSERVATION AND RECREATION</b>  |
| <b>STRUCTURES</b>                           | PICNIC GROUND   |
| HIGHWAY BRIDGE, GENERAL                     | PLAYGROUND, BALL FIELD, ETC.  |
| MINOR DRAINAGE STRUCTURE                    | BATHING BEACH OR SWIMMING POOL  |
|   | SMALL PARK (SP-STATE, CP-COUNTY, MP-MUNICIPAL, WP-WAYSIDE PARK)                       |
|   | GOLF GROUND OR COUNTRY CLUB   |
|   | FAIR GROUND, RACE COURSE, SPEEDWAY  |
|   | DRIVE-IN THEATER  |
|   | <b>PUBLIC SERVICE FACILITIES</b>  |
|   | HIGHWAY GARAGE  |
|   | GARBAGE OR RUBBISH DUMP   |
|   | SEWAGE DISPOSAL PLANT   |
|   | AUTOMOBILE GRAVEYARD  |
|   | WATERFOUL PRODUCTION AREA   |
|   | WATER SUPPLY STAND PIPE OR TANK   |
|   | POWER SUBSTATION  |
|   | COMMUNICATION TOWER   |
|   | <b>INDUSTRIAL</b>   |
|   | STORE OR SMALL BUSINESS ESTABLISHMENT   |
|   | FACTORY OR INDUSTRIAL PLANT   |
|   | GROUP OF STORAGE TANKS (OIL OR GAS)   |
|   | PUMPING STATION (OIL OR GAS)  |
|   | Gauging OR PUMPING STATION  |
|   | WAREHOUSE - GENERAL   |
|   | GRAIN ELEVATOR  |
|   | GRAVEL PIT  |
|   | <b>CITY AND VILLAGE CENTERS</b>   |
|   | COUNTY SEAT   |
|   | OTHER CITIES AND VILLAGES   |
|   | INCORPORATED CITY OR VILLAGE (GENERALIZED)  |
|   | <b>EDUCATIONAL AND CORRECTIONAL INSTITUTIONS</b>                                      |
|   | SCHOOLHOUSE   |
|   | TOWNHALL, GRANGE, OR COMMUNITY HALL   |
|   | <b>NATURAL FEATURES</b>   |
|   | PROMINENT ELEVATION - WITH NAME   |

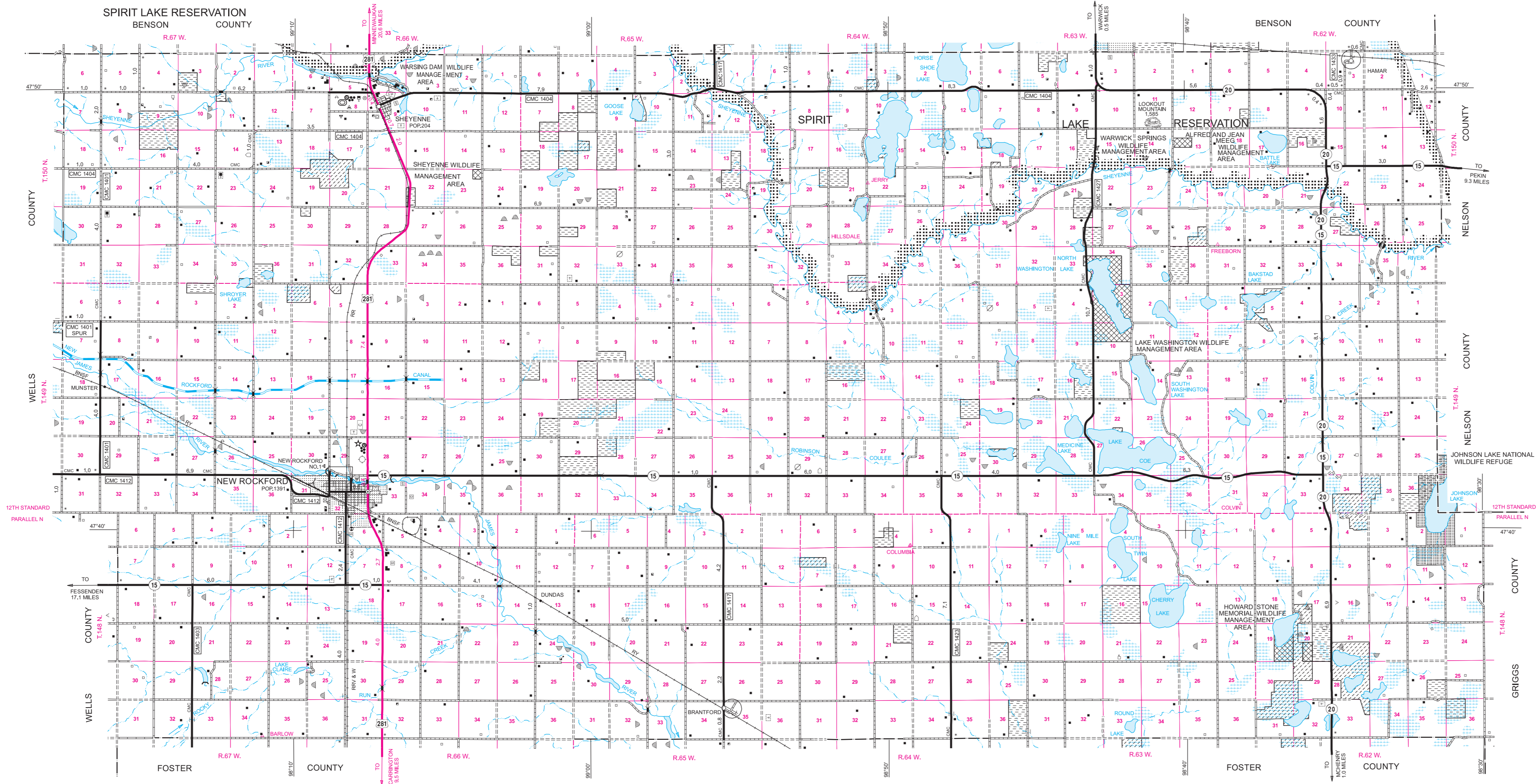
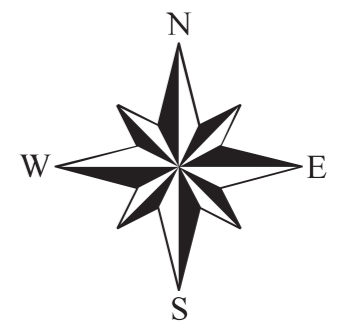

**NAME AND LOCATION OF ORGANIZED CIVIL TOWNSHIPS  
THOSE UNORGANIZED ARE SO NOTED**

- T. 150 N.-R. 67 W. GRANDFIELD
- T. 150 N.-R. 66 W. GATES
- T. 150 N.-R. 65 W. BUSH
- T. 150 N.-R. 64 W. HILLSDALE
- T. 150 N.-R. 63 W. EDDY
- T. 150 N.-R. 62 W. FREEBORN
- T. 149 N.-R. 67 W. MUNSTER
- T. 149 N.-R. 66 W. NEW ROCKFORD
- T. 149 N.-R. 65 W. SHELDON
- T. 149 N.-R. 64 W. TIFFANY
- T. 149 N.-R. 63 W. LAKE WASHINGTON
- T. 149 N.-R. 62 W. COLVIN
- T. 148 N.-R. 67 W. ROSEFIELD
- T. 148 N.-R. 66 W. SUPERIOR
- T. 148 N.-R. 65 W. PLEASANT PRAIRIE
- T. 148 N.-R. 64 W. COLUMBIA
- T. 148 N.-R. 63 W. CHERRY LAKE
- T. 148 N.-R. 62 W. PARADISE

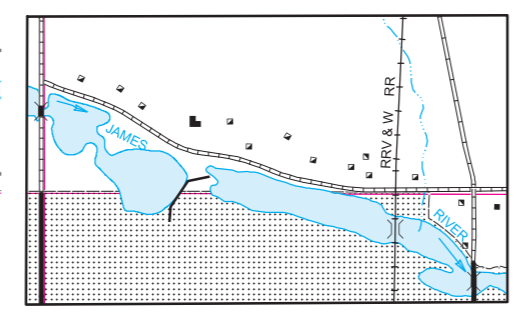

**NEW ROCKFORD NO. 1**  
SECS. 29, 30, 31, & 32 T. 149 N., R. 66 W.

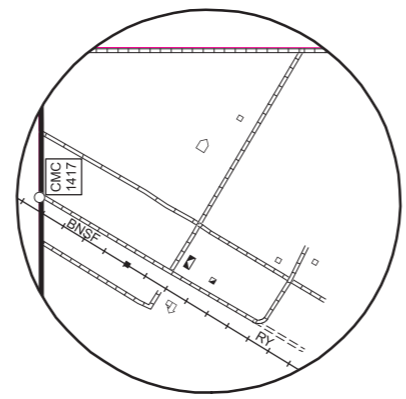

**BRANTFORD**  
SECS. 26, 34, & 35 T. 148 N., R. 65 W.

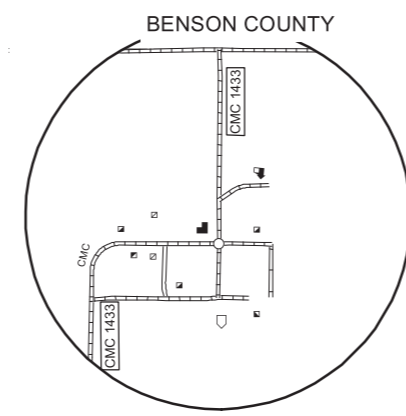

**HAMAR**  
SEC. 3, T. 150 N., R. 62 W.

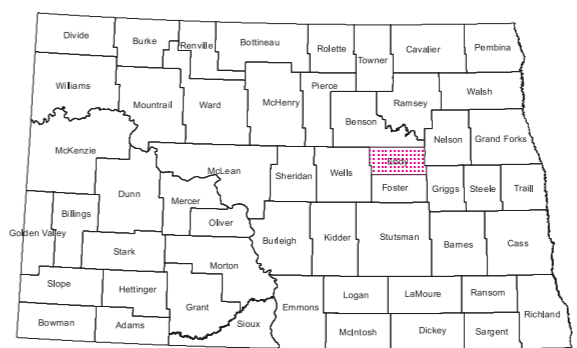

**STATE OF NORTH DAKOTA  
DIAGRAM OF COUNTIES**

**GENERAL HIGHWAY MAP  
EDDY COUNTY  
NORTH DAKOTA**

PREPARED BY THE  
**NORTH DAKOTA DEPARTMENT OF TRANSPORTATION  
PLANNING / ASSET MANAGEMENT DIVISION**  
IN COOPERATION WITH THE  
**U.S. DEPARTMENT OF TRANSPORTATION  
FEDERAL HIGHWAY ADMINISTRATION**

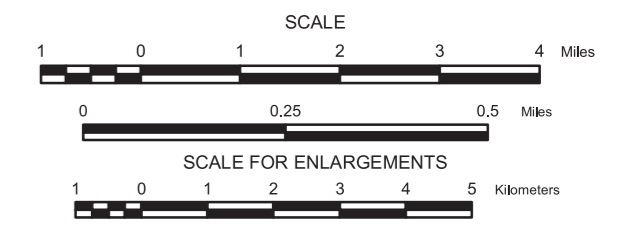

**2016**

BASED ON AERIAL PHOTOGRAPHY OF 1954  
AERIAL INVENTORY OF 2016  
UNIVERSAL TRANSVERSE MERCATOR ZONE 14  
NORTH AMERICAN DATUM 83

**Notice of Disclaimer**  
The North Dakota Department of Transportation (NDDOT) makes this map available on an "as is" basis as a public service. Under no circumstances does NDDOT warrant or certify the information to be free of errors or deficiencies of any kind. NDDOT specifically disclaims all warranties, express or implied, including but not limited to the warranties of merchantability and fitness for a particular purpose.  
COPIES OF THIS MAP ARE AVAILABLE FOR PUBLIC USE AT A NOMINAL COST FROM:  
MAP SALES, ND DEPARTMENT OF TRANSPORTATION, 608 E. BLVD. AVE., BISMARCK, N.D. 58505-0700