

Dollars Current Money) for the due performance of the trust in him
 refused. In testimony whereof I have hereunto set my hand and
 affixed the Seal of office this 4th day of May 1780.

Seal

Test by me Eschberger Registered of Deeds for
 Frederick County Decreed
 (Exhibit No. 1, ad)

Exhibit
 No. 1.

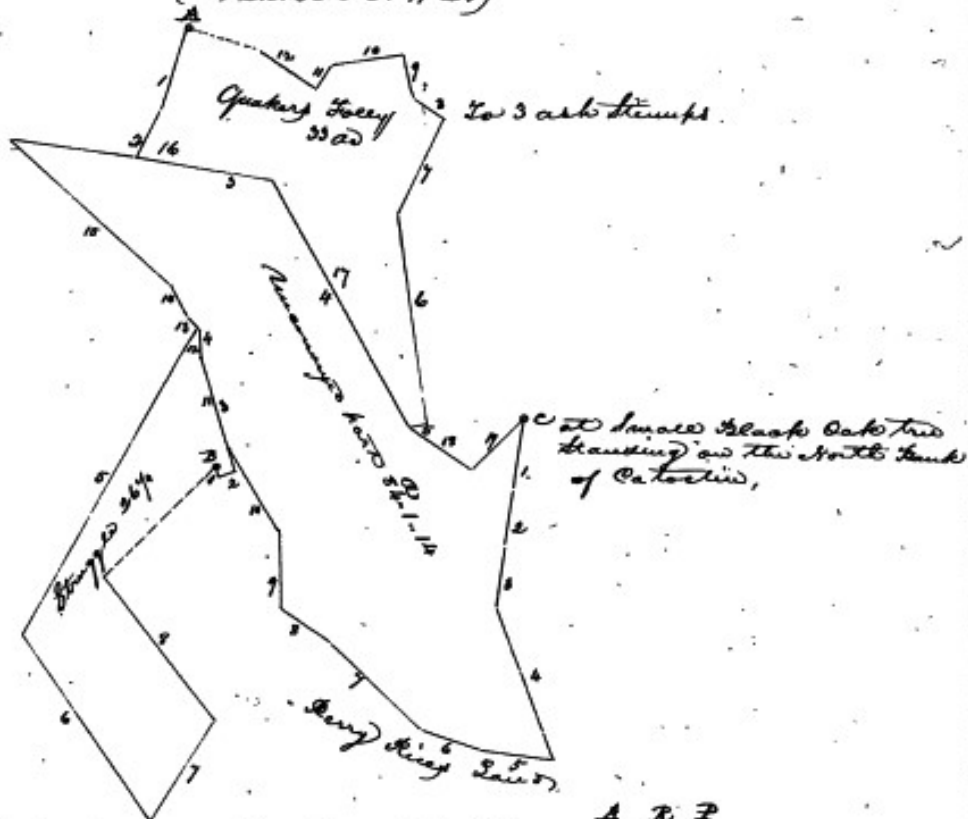

A (The Beginning of Quakers Folly) for	A B C
B Ditto — of Struggles — for	33-0.00
C Ditto — of Lucassey land	26-1.00
	<u>82-1-14</u>
	141-2-14

Quakers Folly granted George House in the year Beginning
 at a thow planted at the end of 28 1/2 perches on the 9th line
 of the Survey, and parts of Anshon and Hope granted Michael
 Barker the 24th day of June 1764 for 600^{rs} ad and running them
 with the 8th line as measured,

- 1 S 75° to 28 1/2 ps
- 2 S 61° to 18 1/2 ps. No interest to the 10th line of Anshon Hope at the
- 3 N 77 1/2° to 46 1/2 ps. 46 1/2 throw them with said to the 10th line reversed
- 4 N 59 1/2° E 96
- 5 N 12 1/2° W to 6 1/2 ps. to the end of the 5th line of Barker thrown with
- 6 S 80° W to 70 ps. to the 10th line thereof
- 7 N 65° W to 34 3/4 ps.
- 8 S 31° W to 11 1/2 ps. To three ash stumps
- 9 S 75° W to 15 1/4 ps. To a thow formerly planted
- 10 S 10° W to 23 1/2 ps. to
- 11 S 57° W to 9 1/2 ps. to
- 12 S 34° W to 23 1/2 ps. To a thow formerly planted by the line of 2 white oak trees
- 13 S 6° W to 34 3/4 ps. To the first place of Beginning containing 33 ad

"Pungge" granted George House in the year... Beginning at a

- 1 N 60 E 64 ps
- 2 N 15 W 5 1/2 ls a corner of Perry Kings land thence with the dividing
- 3 S 72 W 40 1/2 lines between said House and King as now surveyed
- 4 S 87 W 9
- 5 S 60 W 8 1/2 ls a House formerly planted
- 6 S 55 E 7 1/2 ps
- 7 S 57 W 6 40
- 8 S 51 W 60

Then by a straight line to the Beginning for 26 1/2
Courses and Distances as now found the small black oak
tree standing on the North Bank of Catoctin Creek and
running thence down the meanders of said Creek,

- 1 S 84 W 6 34 ps
- 2 S 80 W 6 14
- 3 S 83 W 6 22 thence having said Creek
- 4 N 68 W 6 50 1/2 ls interest the 10 line of a tract of land called
- 5 S 6 W 10 35 1/2 Neighbours Blawie at the end of 28 1/2 ps thence
- 6 S 19 W 10 20 thence with said line to Course
- 7 S 43 W 10 42
- 8 S 35 W 10 20
- 9 S 89 W 10 26 across the Creek
- 10 S 57 W 10 33 1/2 ls interest the 5th line of a tract of land called
- 11 S 72 W 10 30 1/2 Struggle at the end of 9 1/2 ps thence thence with
- 12 S 87 W 10 9 said line,
- 13 S 44 W 10 6
- 14 S 60 W 10 12
- 15 S 41 W 10 70
- 16 N 7 W 6 44 to the end of the 2nd line of a tract of land called
- 17 N 7 W 2 46 1/2 Quakers Ferry, thence with said line two Courses
- 18 N 59 W 2 94
- 19 N 53 W 6 25 thence across Catoctin Creek to the black
oak tree at the first place of Beginning for 84

A true Copy attested
Joseph Fellows

decreed
of the
House

whereupon the following answer was filed viz
The separate answer of Elitha House one of the Defendants to
the Bill of Complaint of Elijah House against the said Elitha
House, Perry House, Martha House, Wm House, and George House
in the Frederick County Court sitting as a Court of Equity, the
Defendant having to himself now and at all times
hereafter all and all manner of advantage of exception
to the many errors, exceptions and informalities in
the complainants said Bill of Complaint states for
answer to said Bill of Complaint, or unto to work
thereof as is material or necessary for him to make
answer unto that all the facts stated in said