

No. 6415 Equity

Commissioner
Report of Midson
Down,

Beginning for the same at the end of 264 feet on a line drawn Eastwardly with the South side of East All Saint Street from the South East corner of Market and all Saints Streets and running thence through the Brick building standing on said property and with the west side of the first partition wall in said building S 10° N 148 feet to the end of 78 7/8 feet on the fourth line of the whole property hereafter described thence by and with said fourth line S 78 3/4° E 157 1/2 feet to the end of said fourth line thence by and with the fifth line thereof N 10° E. 148 feet, to being the north west corner of Philip Leitchew's property and on the south side of All Saints Street of record and with the South side thereof N 78 3/4° N. 157 1/2 feet to the beginning.

The following are the courses and distances of the whole Real Estate of which Henry J. Walling late of Frederick County deceased died seized and possessed Beginning for the same on the South side of all Saints Street from the South East corner of Market and All Saints Streets. It being at the end of the third line of a deed from Henry J. Walling and wife to Sarah W. Sumner by deed dated the 9th of November 1847, Recorded in Liber W. B. T No. 6 folio 386 one of the Land Records of Frederick County, and running with the line of said Deed 2 courses reversed to wit: S 10° N 130 feet N 78 3/4° N 8 feet, thence S 10° N. 18 feet, thence S 78 3/4° E 93 1/2 feet N 10° E 148 feet to the South side of all Saints Street aforesaid and with it N 78 3/4° N 85 1/2 feet to the Beginning All of which is respectfully submitted.

Witness our hands and seals this day of April A.D. 1896.

- W. J. McMillin
- James E. Walker
- Richard J. Hargett
- Harry E. Strick
- Edward J. J.

East All Saint Street

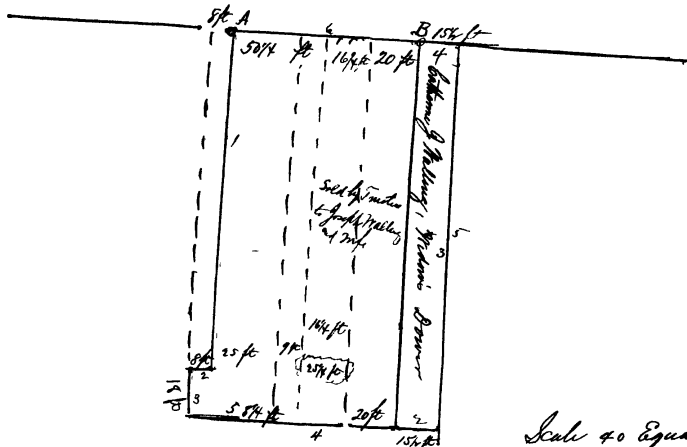

- Courses from A
- 1 S 10° N 130 feet
 - 2 N. 78 3/4° N 8 "
 - 3 S. 10° N 18 "
 - 4 S 78 3/4° E. 93 1/2 "
 - 5 N. 10° E. 148 "
 - 6 N. 78 3/4° N. 85 1/2 " to Beginning

- Courses from B
- 1 S. 10° N 148 feet
 - 2 S 78 3/4° E. 157 1/2 "
 - 3 N 10° E. 148 "
 - 4 N 78 3/4° N 157 1/2 " to Beg.
- Containing 2232 sq ft

Scale 40 Equal parts
Per R. A. Rager
April 8. 1896