

Frederick Co, Maryland

Equity DHH-1, 393

The following is a plat and description of a lot of ground situated lying and being in Frederick County and at the East end of The B. & O. R. Tunnel at the Point of Rocks. It being the same lot or portion of ground of which Benjamin Chambers late of Frederick County, died seized and possessed, and which said lot or portion of ground is now (to wit) (March 8th 1877) instrumentally divided into (3) separate lots at the instance of Messrs. McKell Belt and Coke Chambers Executors, Mortgages, Requiring for the Outlines of the whole lot at the end of the 13th on R 1822 C. 170 P. and expressed in a deed from Leon Thomas Trustee to Henry Culler and Sebastian Ramsburg by deed dated August 27th A.D. 1842, and recorded in Liber W. S. No. 17, Folio 66 one of the Land Records of Frederick County, it being near the North Rail of the South Track of the B. & O. R. R. aforesaid and at the East end of the Tunnel aforesaid and running thence by and with the original lines of the deed aforesaid being the 14th, 15th and 16th and 17th lines of said deed. (1st) North  $4^{\frac{1}{2}}$  P. to the end of the 4th line of a deed from John P. Wright to Mrs. Josephine Cross, thence by and with the 5th and last line of said deed (2nd) S  $86^{\circ}$  E  $4^{\frac{1}{2}}$  P. to the beginning of said deed, thence still with the outlines of the deed aforesaid from Leon Thomas Trustee to Ramsburg and Culler (3rd) N  $70^{\circ}$  E  $4^{\frac{1}{2}}$  P. to a stake (4th) N  $65^{\circ}$  E. 3 P. to the end of the 2nd line of a deed from Casper Mautz Trustee, to Thomas Dixon, thence by and with said second line reversed as the same now bears.

No. 67 1/2 Equity.  
 S.  $2\frac{1}{2}^{\circ}$  E  $9\frac{1}{2}$  P., to the North Margin of the Baltimore and  
 Ohio Rail Road aforesaid thence N.  $76^{\circ}$  N.  $11\frac{1}{2}$  P., = 188<sup>00</sup>/<sub>100</sub> feet  
 to the beginning.

Lot No. 1.

Beginning at the beginning of the whole lot aforesaid and  
 running thence (1st) North  $4\frac{1}{2}$  P., to the end of the 5th line, of  
 a deed from John P. Wright to Mrs. Josephine Cross, thence  
 by and with the 5th and last line of said deed (2nd) S.  $86^{\circ}$   
 E  $4\frac{1}{2}$  P., to the Beginning of said deed, still with the orig-  
 inal outlines of the deed from Levin Thomas Trustee to  
 Culler and Rainsburg (3) N.  $70\frac{1}{2}^{\circ}$  E  $1\frac{1}{2}$  P., to a stake thence by  
 a line of division between lots Nos 1 and 2, (4th) S.  $13\frac{1}{4}^{\circ}$  N.  $5\frac{1}{2}$   
 P., to the end of  $6\frac{1}{2}$  P., on the 6th or N.  $76^{\circ}$  N.  $11\frac{1}{2}$  P., line of  
 the whole lot and with it N.  $76^{\circ}$  N.  $4\frac{1}{2}$  P., = 81<sup>00</sup>/<sub>100</sub> feet to the  
 beginning.

Lot No. 2.

Beginning at a stake at the end of the 3rd line of lot  
 No. 1, and running thence (1st) N.  $70\frac{1}{2}^{\circ}$  E  $2\frac{1}{2}$  P., to a stake it being  
 the end of the 6th line expressed in the deed from Leylon  
 Thomas, Trustee, to Culler and Rainsburg, thence by and  
 with the 17th line of said deed (2nd) N.  $65^{\circ}$  E  $7\frac{1}{2}$  P. or a Perch to a  
 stake in said line, thence by a line of division between lots  
 Nos. 2 and 3 (3rd) S.  $8\frac{3}{4}^{\circ}$  N.  $7\frac{1}{2}$  P., to the North Margin of the  
 B. & O. R. R., aforesaid and at the end of  $3\frac{3}{4}$  P., on the 6th line  
 of the whole lot and with it, N.  $76^{\circ}$  N.  $3\frac{1}{2}$  P., = 51<sup>00</sup>/<sub>100</sub> feet to the end  
 of the 4th line of lot No. 1, and with it reversed N.  $13\frac{1}{4}^{\circ}$  E  $5\frac{1}{2}$  P., to  
 the beginning.

Lot No. 3.

Beginning at a stake at the end of the 2nd line of lot  
 No. 2, it also being at the end of  $\frac{2}{3}$  of a Perch on the 17th or N.  
 N.  $65^{\circ}$  E  $3$  P., line of the deed aforesaid from Levin Thomas  
 Trustee to Culler and Rainsburg, thence by and with said 17th  
 line (1st) N.  $65^{\circ}$  E  $2\frac{3}{4}$  P., to a stake at the end thereof, it also  
 being at the end of the second line of the deed aforesaid  
 from Casper Mantz, Trustee to Thomas Dixon, thence by and  
 with said 2nd line reversed as the same now lead (2nd)  
 S.  $2\frac{1}{2}^{\circ}$  E  $7\frac{1}{2}$  P., to the North margin of the B. & O. R. R., aforesaid  
 thence (3rd) N.  $76^{\circ}$  N.  $3\frac{1}{2}$  P., = 53<sup>00</sup>/<sub>100</sub> feet, to the end of  
 the 3rd line of Lot No. 2 and with it reversed (4th) N.  
 $8\frac{3}{4}^{\circ}$  E  $7\frac{1}{2}$  P., to the beginning.

Surveyed March 8th 1897.

Per. R. H. Roger

No. 6712 Equity.

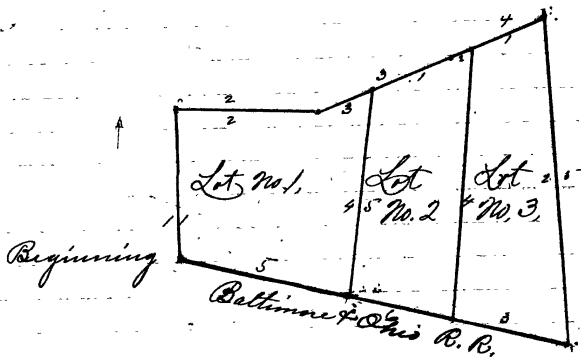

Scale of One off scale of  
30 equal parts.  
Per. R. A. Rager,