

COLORADO
 From Columbus Public Library: April 21, 1847...sighted Pawnee village...camped on other side of it. Latitude 41° 22' 37" (Monroe Area). April 22...crossed Beaver Creek...On April 24 could postpone crossing (Loup River) no longer...much difficulty with quicksands. Traveled along north bank because of quicksands, taking them more than 40 miles north of intended course and more than 20 miles north of the Platte river. Avoided Oregon trail because of anti-Mormon sentiment in St. Louis. Joined Oregon trail at Kearney.
 From a private diary: "Came upon a small stream and some shade trees. There we camped and rested a few days." NOTE: The large cottonwood tree at Oconee, Nebraska is believed by an historian who traced the authors' route, to be the remaining tree as its diameter is large enough to be about 150 years old, or more. (May, 1995) These are obviously accounts of two different parties.

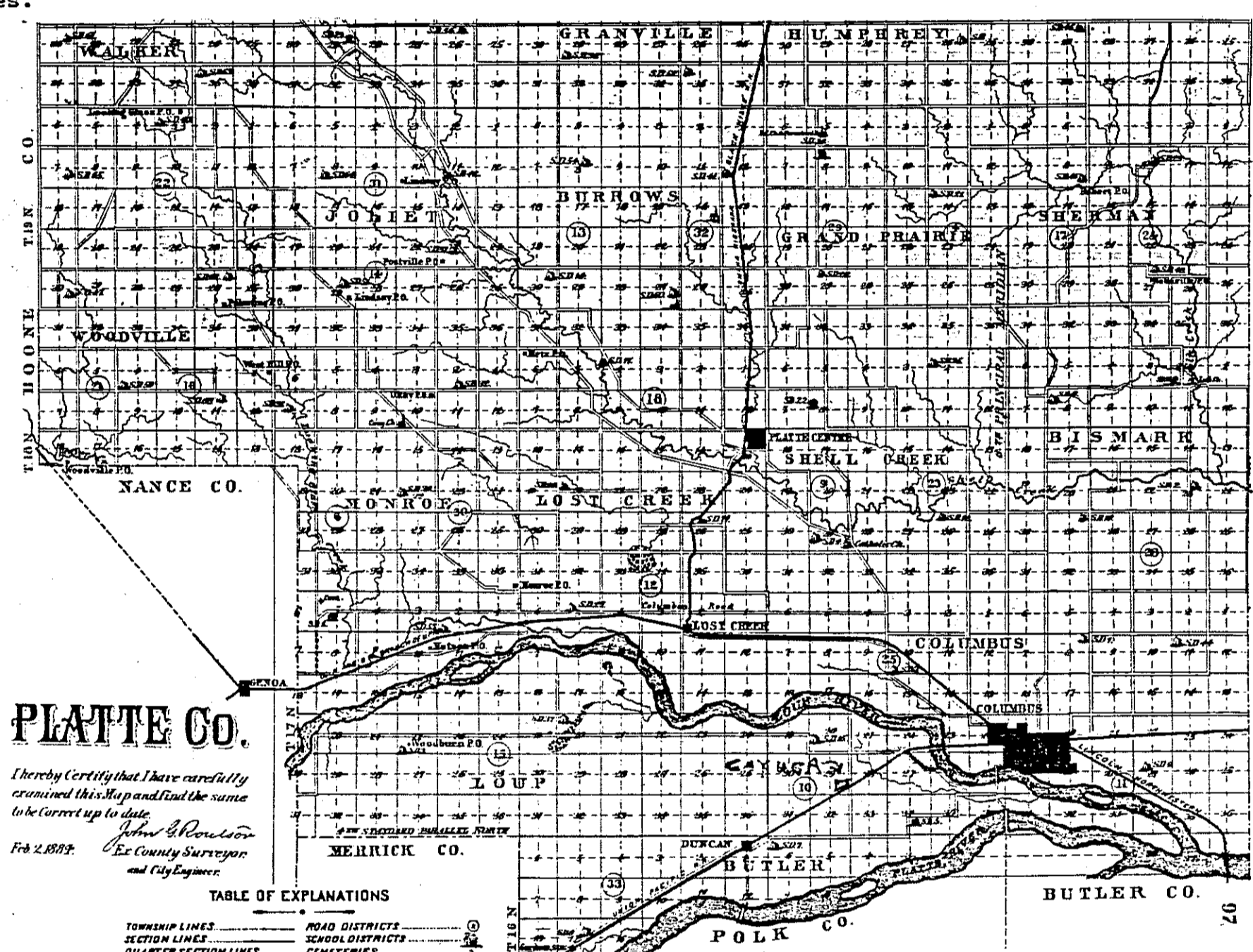

PLATTE CO.

Showing Certified True and Correctly
 Approved the Register of Deeds Office
 in accordance with the laws of Nebraska
 FA 1889 Philip H. Williams
 Register of Deeds

TABLE OF EXPLANATIONS

Section Lines	Range Lines	Section Corners	Section Boundaries
Section Corners	Section Boundaries	Section Corners	Section Boundaries
Section Corners	Section Boundaries	Section Corners	Section Boundaries
Section Corners	Section Boundaries	Section Corners	Section Boundaries

TOWNSHIP No. 11 North, of RANGE No. 1 West of the 6th Principal MERIDIAN, Nebraska

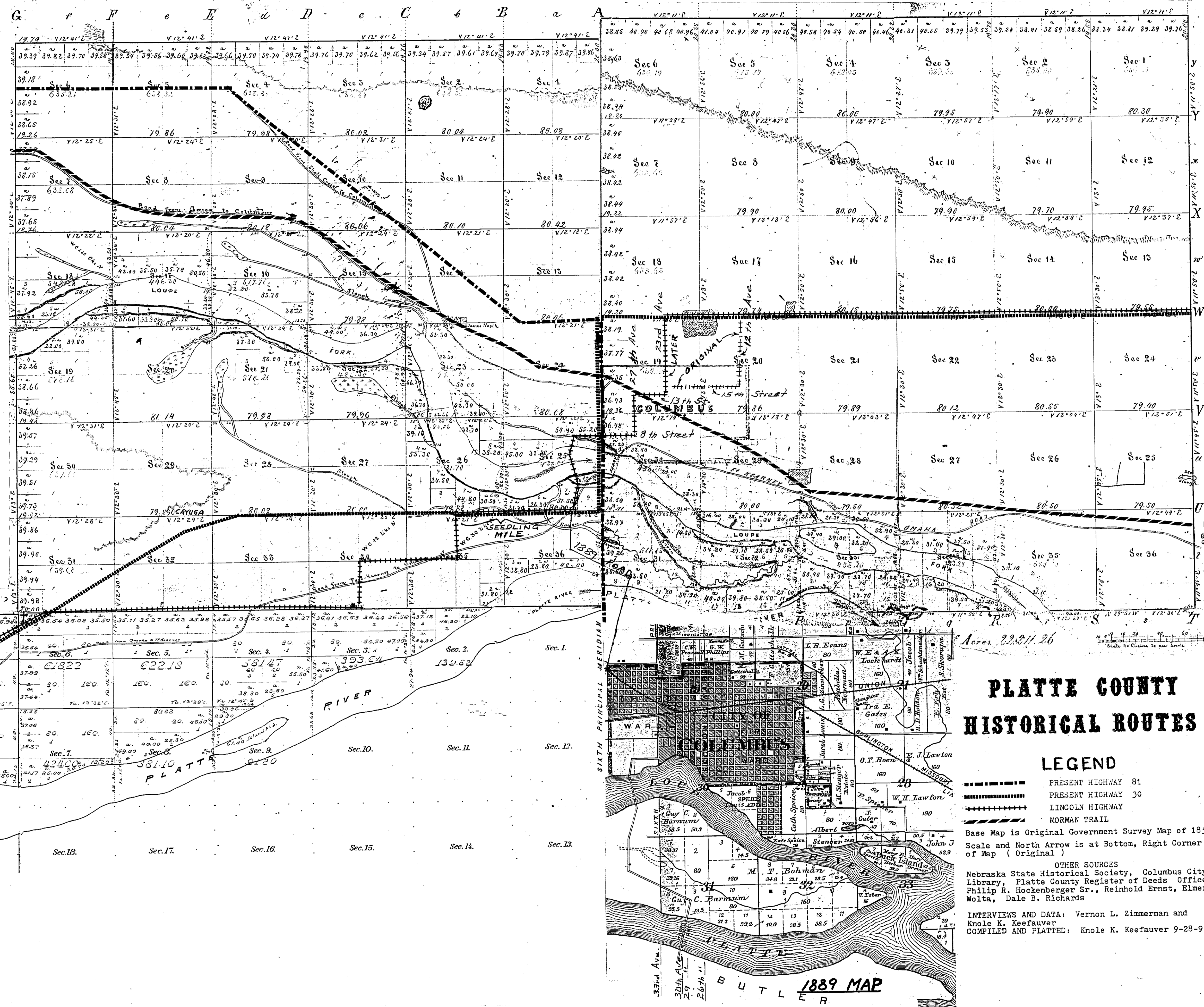

**PLATTE COUNTY
 HISTORICAL ROUTES**

LEGEND

- PRESENT HIGHWAY 81
- PRESENT HIGHWAY 30
- LINCOLN HIGHWAY
- MORMAN TRAIL

Base Map is Original Government Survey Map of 1858
 Scale and North Arrow is at Bottom, Right Corner
 of Map (Original)

OTHER SOURCES
 Nebraska State Historical Society, Columbus City
 Library, Platte County Register of Deeds Office
 Philip R. Hockenberger Sr., Reinhold Ernst, Elmer
 Wolta, Dale B. Richards

INTERVIEWS AND DATA: Vernon L. Zimmerman and
 Knole K. Keefeaver
COMPILED AND PLATTED: Knole K. Keefeaver 9-28-95

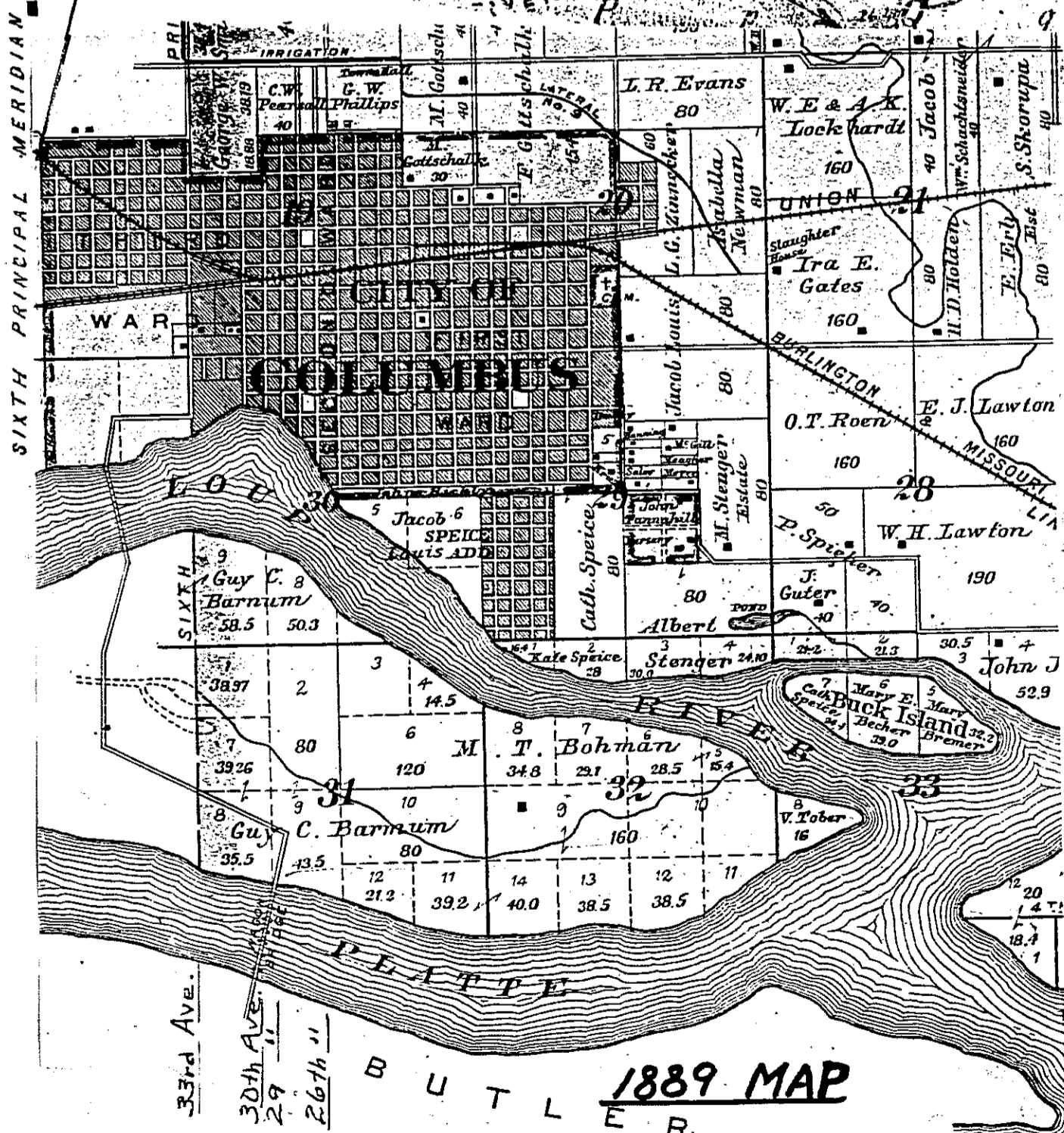

1/2 - 2 West